

Forensic Scientist (Latent Prints)

[Click Here to Apply](#)

Application Deadline: Open until filled

The Johnson County Sheriff's Office Criminalistics Laboratory is seeking qualified applicants to fill one Forensic Scientist position in our Latent Prints Section.

Position Summary

- Location: Olathe, KS 66061
- Full-Time, 40 hours
- Work Schedule: Monday - Friday, with flexibility in start times and length of workdays (up to 12 hours)
- Positions will be hired as a **Forensic Scientist** or **Senior Forensic Scientist**, based upon qualifications and prior experience.
- Hiring salary will be based upon experience and equity within the laboratory and is non-negotiable.



Position Duties, Experience Requirements, and Compensation

Forensic Scientist: \$29.44 – \$44.16 (\$61,235 - \$91,852 annualized)

- **Job Description:** Performs specialized forensic examinations of submitted evidence in at least one forensic science discipline. Carries out a range of professional forensic assignments, conducts scientific testing, interprets test results, forms conclusions, prepares technical reports, provides scientific consultation, and testifies as an expert witness in a court of law.
- **Experience Requirements:** Successful completion of a training program with demonstrated competency within the relevant forensic discipline and one year of experience in a forensic laboratory as a Forensic Technician or Forensic Scientist.

Senior Forensic Scientist: \$32.23 – \$48.35 (\$67,038 - \$100,568 annualized)

- **Job Description:** Performs specialized forensic examinations of submitted evidence in at least one forensic science discipline. Carries out a range of professional forensic scientist assignments, exercising considerable independent judgment regarding complex/nontraditional casework. Conducts scientific testing, interprets test results, forms conclusions, prepares technical reports, provides scientific consultation, and testifies as an expert witness in a court of law.
- **Experience Requirements:** Successful completion of a training program with demonstrated competency within the relevant forensic discipline and five years of independent forensic casework in the relevant discipline.

General Duties in Latent Prints

In addition to the above descriptions, the major duties of this position include, but are not limited to:

- Examining developed latent prints utilizing the ACE-V process.
- Processing evidence, utilizing various chemical and physical methods, to develop latent prints.
- Utilizing local and national finger/palm print databases.
- Performing technical and administrative review of case data.
- Documenting and performing casework duties in accordance with laboratory procedures with minimal errors and no patterns of deficiencies.
- Participating in training, competency testing, and proficiency testing according to established protocols.
- Performing maintenance, and complex troubleshooting of equipment, and software to ensure the integrity of testing.
- Rigorously following all safety manuals, standard operating procedures, and quality assurance/quality control procedures.
- Performing quality assurance/quality control procedures of reagents, equipment, and instrumentation as necessary.
- Assisting in ensuring conformance to laboratory accreditation standards.
- Attending continuing education/training courses, workshops, seminars, conferences, and professional meetings as time and resources allow.
- Participating in method validation/verification studies as needed.
- Presenting information regarding crime scene processing and evidence collection techniques to law enforcement and/or citizens.
- Providing expert testimony in courts of law as required.

Educational Requirements

Graduation from an accredited college or university with a minimum of a bachelor's degree in a chemical, physical, or biological science, forensic science, or other relevant field.

Preferred Qualifications

The following certifications are preferred but NOT required: Latent Print Certification through the International Association for Identification (IAI).

Pre-employment Requirements

- If selected for a position you must submit and pass a polygraph examination, extensive background check, drug screen, and psychological interview prior to starting employment.
- You will also be required to provide a known DNA sample for quality assurance purposes.

Benefits

2025 benefits include:

- 11 county-paid holidays, 2 floating holidays, and accrual of sick and vacation leave.
- Parental, caregiver, shared, civic, military, and bereavement leave.
- Dental, medical, and vision insurance.
- Reimbursement of approved education expenses up to \$3,500 per calendar year, as resources allow.
- Access to on-site fitness center.
- Fitness program that pays for classes and memberships in a network of over 160 facilities, studios, and gyms.
- County match of up to 4% of your base bi-weekly earnings towards a retirement saving contribution program.
- Kansas Public Employee Retirement System (KPERS).
- Sick disability pay and provided term life and accidental death and dismemberment insurance.
- Employee Assistance Program to provide confidential assistance regarding physical and emotional health.
- Flexible Spending Accounts (medical and dependent care reimbursement).
- Employee discounts for products, entertainment, attractions, sports, and events.

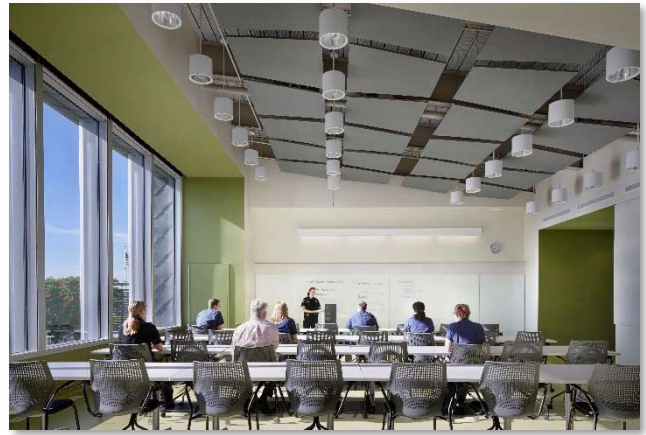

About Us

The Johnson County Sheriff's Office Criminalistics Laboratory is a state-of-the-art, internationally accredited, 62,000 square foot facility located in the southwest quadrant of the Kansas City metropolitan area. We provide forensic services to all law enforcement agencies located or operating within Johnson County, Kansas. Find out more about us at [Johnson County Sheriff | \(jocosheriff.org\)](http://jocosheriff.org).

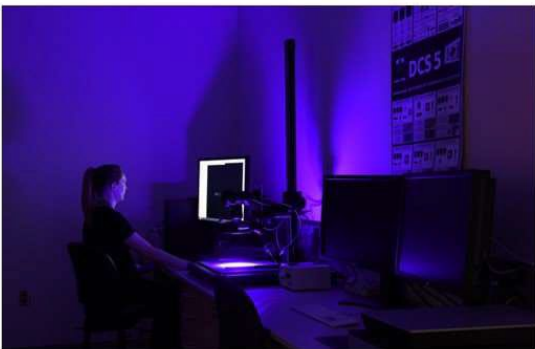

**Criminalistics
Laboratory**
JOHNSON COUNTY
SHERIFF'S OFFICE